

KEY	QTY
TREES	

KEY	QTY	PLANT AND SPECIFICATION
TREES		
** AM2	2	Adonia merrillii (Double Adonia Palm) 12' ht., double, heavy, matched
** N CES	4	Conocarpus erectus 'Sericeus' (Silver Buttonwood) 12' ht., 5' spr., standard, 5' c.t., 2" cal., matched
** N CE	3	Conocarpus erectus (Green Buttonwood) 16' ht., 6' spr., standard, 7' c.t., min. 3" cal., matched
** N CD	8	Coccoloba diversifolia (Pigeon Plum) 16' ht., 6' spr., standard, 6' c.t., min. 3" cal., matched
** CN	4	Cocos nucifera (Coconut Palm) 12'-14' g.w., heavy, matched
** ED	6	Elaeocarpus decipiens (Japanese Blueberry) 12' ht., 4' spr., standard, 3' c.t., 2" cal., matched
PE	8	Ptychosperma elegans (Alexander Palm) 22' o.a. ht., single, matched
PE2	14	Ptychosperma elegans (Triple Alexander Palm) 22' o.a. ht., double, matched
PE3	5	Ptychosperma elegans (Triple Alexander Palm) 12'-14' o.a. ht., triple, matched
VM	3	Veitchia montgomeryana (Double Montgomery Palm) 16' o.a. ht., double, heavy, matched

KEY	QTY	PLANT AND SPECIFICATION
<u>SHRUBS, GROUNDCOVERS & ACCENTS</u>		

** N	CHR	50	Chrysobalanus icaco 'Horizontalis' (Horizontal Cocoplum) 16" ht., 16" spr., 24" o.c., full
** N	CRI	3	Crinum sp. (White Crinum Lily) 36" o.a., full, 3 p.p.p., full
	DIO	3	Dioon edule 4' o.a., symmetrical, matched
**	FGI	89	Ficus microcarpa 'Green Island' 14" ht., 14" spr., 18" o.c., full
	FIC	35	Ficus pumila (Creeping Fig) 12" o.a., 12" runners, 12" o.c., full
**	LAN	40	Lantana (Yellow Trailing Lantana) 14" o.a., 16" o.c., full
	MIC	36	Microsorium scolopendria (Wart Fern) 14" ht., 14" spr., 18" o.c., full
	PBM	202	Philodendron 'Burle Marx' 14" ht., 14" spr., 18" o.c., full
	PHI	3	Philodendron giganteum 30" ht., 30" spr., full, matched
** N	PSY	152	Psychotria nervosa (Wild Coffee Hedge) 3' ht., 24" spr., 24" o.c., full
** N	PEN	50	Pennisetum setaceum (White Fountain Grass) 30" ht., 20" spr., 24" o.c., full
	POD	149	Podocarpus macrophyllis (Podocarpus Hedge) 5' ht., 24" spr., 24" o.c., full
	PRI	89	Podocarpus macrophyllis 'Pringles' 14" ht., 14" spr., 18" o.c., full
**	PR3	3	Phoenix roebelenii (Triple Pygmy Date Palm) 5' o.a., triple, matched, heavy, full
** N	TR	2	Thrinax radiata (Tatch Palm) 4' ht., 3' spr., heavy, matched
	SOD		St. Augustine 'Palmetto' Contractor to determine quantity.
	MULCH		3" depth, dark brown, non-Cypress mulch Contractor to determine quantity.
	SLATE CHIPS		3" depth, medium size Contractor to determine quantity.
N DENOTES NATIVE SPECIES			
** FLORIDA-FRIENDLY SPECIES			

INTRACOASTAL WATERWAY

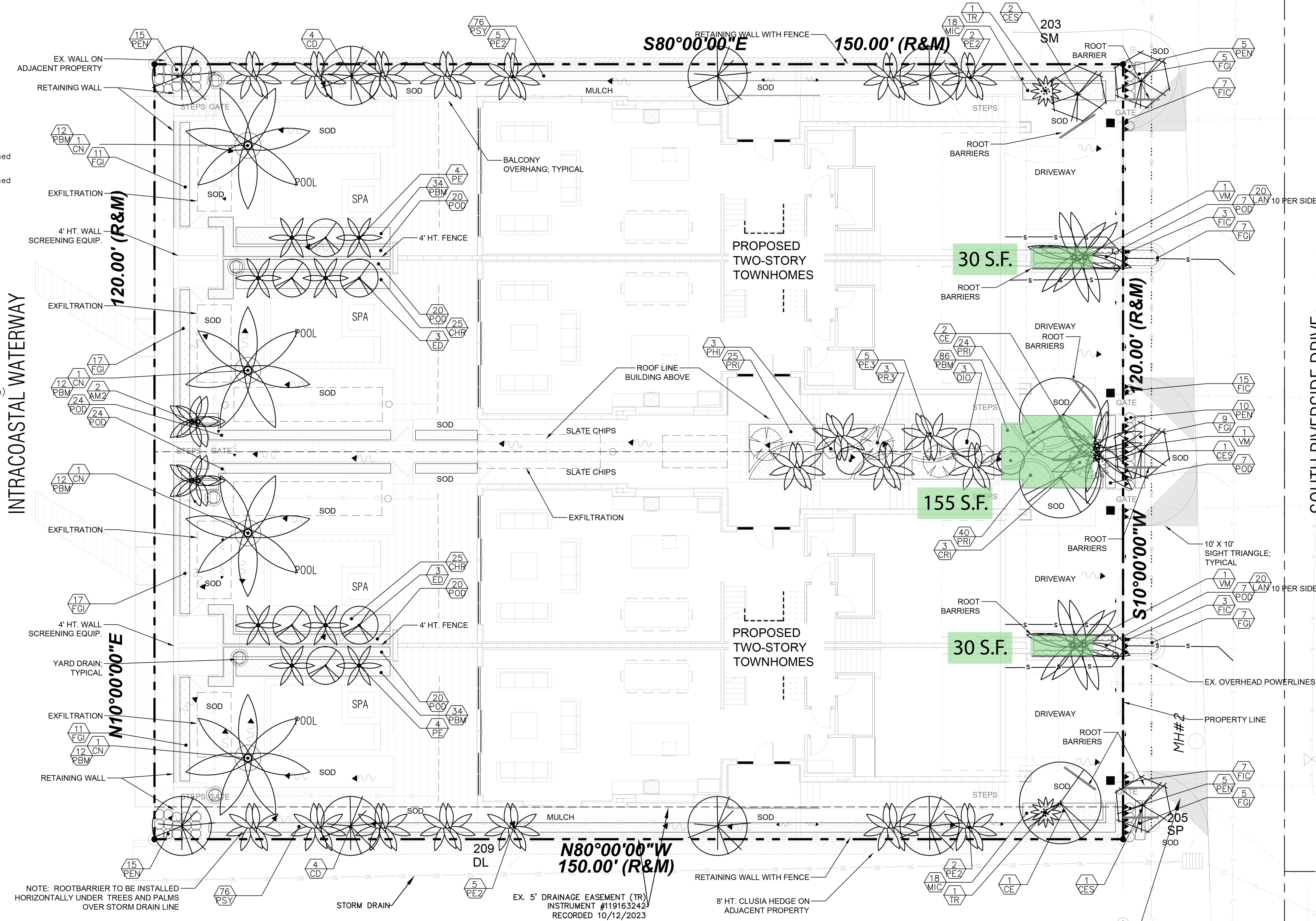

TREE MITIGATION DATA

TREE REPLACEMENT: ADD 1 CALIPER INCH PER 1 DBH INCH REMOVED IN ADDITION TO REQUIRED TREES
 TOTAL DBH INCHES REMOVED: 160 INCHES
 TOTAL CALIPER INCHES PROPOSED: 0 INCHES
 MITIGATION REPLACEMENT WILL BE PAID TO THE CITY OF POMPANO BEACH TREE FUND

PALM REPLACEMENT: 1 FOR 1
TOTAL PALMS REMOVED: 7 PALMS
TOTAL PALMS PROPOSED: 7 PALMS

ITEM	REMOVED	REPLACED
\$ SPECIMEN VALUE	\$0	\$14,350 TREES REPLACED
PALM HEIGHT	108'	664'
DBH (NON-SPECIMEN)	160"	53" CALIPER

SITE CALCULATIONS

ITEMS	REQUIRED	PROPOSED
A. TOTAL LOT AREA		18,000 S.F.
B. STRUCTURE, WALKWAYS, DRIVESWAYS, ETC	13,500 S.F.	13,458 S.F.
C. PERVIOUS LOT AREA	4,500 S.F. (25%)	4,542 S.F. (25.23%)

EXISTING TREE SYMBOLS



EXISTING TREE KEY

KEY	NAME
DL	Areca Palm
SM	Mahogany
SP	Sabal Palm

CITY OF POMPANO NOTES

1. IF THE TREES ARE TO BE CANTERINIZED THE ROOT BALL SHALL BE SHAVED AT THE PERIPHERY TO REMOVE ALL CIRCLING ROOTS.
2. PLANT SPACING SHALL SUPERSEDE PLANT QUANTITY TO FILL THE BED
3. AS PER 155.5204.F. NO DEVELOPMENT, WORK, OR DEMO ACTIVITY SHALL BE ALLOWED WITHIN THE DRILLPIE OF A TREE OR TREE PROTECTION AREA.
4. FINES AND PENALTIES FOR ENCROACHMENT INTO THE CRITICAL ROOT ZONES AND WITHIN THE TREE PROTECTION ZONE FOR EXISTING TREES TO BE PROTECTED AND PRESERVED.
5. ALL EXISTING TREES WILL BE PRUNED BY AN ISA CERTIFIED ARBORIST UNDER THE DIRECTION OF A BCMA OR ASCA REGISTERED CONSULTING ARBORIST.
6. AS PER 155.5204.F.3.4.; UNDERGROUND UTILITY LINES SHALL BE ROUTED AROUND THE TREE PROTECTION AREA WHERE POSSIBLE. IF THIS IS NOT POSSIBLE, A TUNNEL MADE BY A POWER-DRIVEN SOIL AUGER MAY BE USED UNDER THE TREE.
7. ALL TREES DESIGNATED AS SINGLE TRUNK SHALL HAVE A SINGLE, RELATIVELY STRAIGHT, DOMINANT LEADER. PROPER STRUCTURAL BRANCHING AND EVEN BRANCH DISTRIBUTION. TREES WITH INCLINED, TIPPED BRANCHES, AND CO-DOMINANT TRUNKS WILL NOT BE ACCEPTED. TREES WITH GIRDLING, INTACT LEADER CIRCLING AND/OR PLUNGING ROOTS WILL BE REJECTED.
8. ALL HEDGES ABUTTING CITY STAFFS OF WAY ARE MAINTAINED AT A HEIGHT NO GREATER THAN 24". IT IS STAFFS RECOMMENDATION THAT ALL TREES VIA PERIMETER TREES BE 14' O.A TO CREATE A LARGEST CTED CLEAR LINE OF SIGHT FROM ROADWAY.
9. PRE-CONSTRUCTION MEETING WITH URBAN FORESTRY IS REQUIRED BEFORE ANY PLANT MATERIAL IS INSTALLED ON SITE.
10. ALL ROAD ROCK, CONCRETE, ASPHALT AND OTHER NON NATURAL MATERIAL BE REMOVED FROM ALL PLANTING AREAS PRIOR TO LANDSCAPE INSTALLATION AND BE REPLACED WITH PLANTING SOIL PRIOR TO LANDSCAPE INSTALLATION.
11. ALL TREE WORK WILL REQUIRE PERMITTING BY A REGISTERED BROWARD COUNTY TREE TRIMMER.
12. LANDSCAPE MATERIALS OTHER THAN SOD ARE NOT ALLOWED WITHIN 5' OF ANY PORTION OF CITY OWNED UTILITIES.
13. ALL LANDSCAPE MATERIAL WILL BE FLORIDA #1 GRADE OR BETTER.

14. ALL INVASIVE TREES AND PLANTS SHALL BE REMOVED FROM THE SITE AND ADJACENT CANAL OR IF ENCRANCHING FROM ADJACENT PROPERTY TO THE NORTH THEY SHALL BE CUT BACK TO THE PROPERTY LINE.
15. ALL EXISTING TREES TO REMAIN SHALL BE PRUNED FOR STRUCTURE, CLEARANCE, CORRECTIVE AND RESTORATION PRUNING OF ANY DAMAGED LIMBS.
16. ALL CANOPY AND ROOT PRUNING SPECIFICATIONS AND PRUNING OVERSIGHT, SHALL BE PROVIDED BY AN ISA BOARD CERTIFIED MASTER ARBORIST WITH AN ISA PPQ QUALIFICATION AND ASCA CERTIFIED. THE PRUNING WORK SHALL BE COMPLETED UNDER THEIR DIRECTION BY AN ISA CERTIFIED ARBORIST OR BROWARD COUNTY REGISTERED TREE TRIMMER.
- TABLE 155.5203.C IS PROVIDED AS PER CITY COMMENTS.
- HOWEVER, ORDINANCE 2015-15 IS THE BASIS FOR THE MINIMUM DEVELOPMENT SITE LANDSCAPE. LANDSCAPE MEETS AND EXCEEDS THE MINIMUM SITE LANDSCAPING AS PER ORDINANCE 2015-15.

NOTES

3. AS PER CITY ORDINANCE (S) § 50.02(A) (3) AND § 100.35(C), THAT LANDSCAPING MATERIALS OTHER THAN SOD ARE NOT ALLOWED WITHIN 5' FIVE FEET OF ANY PORTION OF CITY-OWNED UTILITIES OTHER THAN THE PUBLIC STREET RIGHT OF WAY INCLUDING METERS, HYDRANTS, SERVICE LINES ETC. ALSO, PLEASE NOTE THAT NO TREES, SHRUBBERY OR OBSTRUCTION SHALL BE PLACED WITHIN A 3' RADIUS OF A CITY-OWNED SEWER LATERAL, CLEANOUT OR WATER &/ OR REUSE METER. SHOW THE LOCATION OF ALL CITY-OWNED AND MAINTAINED POTABLE WATER MAINS AND SERVICES, SANITARY SEWER MAINS OR LATERALS AND STORM DRAINAGE LINES ON THE PROPOSED LANDSCAPE PLANS. CONTACT TRACY WYNN, GIS COORDINATOR ENGINEERING DIV, FOR UTILITY INFORMATION. 954-545-7007 TRACY.WYNN@COPBFL.COM ENGINEERING STANDARD STREET TREE DETAIL 316-1 AND 315-1.
2. PENALTIES WOULD BE INCURRED BY THE CONTRACTOR FOR DAMAGES TO THE EXISTING TREES ON SITE FROM THE CONTRACTOR, THE SUBCONTRACTORS, OR EMPLOYEES: ANY ENCROACHMENT WITHIN THE TREE PROTECTION ZONE, FAILURE TO MAINTAIN THE TREE PROTECTION ZONE, OR ANY DAMAGE TO THE TREE OR CRITICAL ROOT ZONES WILL RESULT IN MITIGATION COSTS. DAMAGE TO TREES WOULD INCLUDE, BUT NOT BE LIMITED TO, STORAGE OF MATERIALS, PLACING FILLS OR DEBRIS, DISPOSAL OF PAINT OR SOLVENTS, PARKING OF MACHINES UNDER TREES OR TREE PROTECTION ZONE ENCROACHMENT. AN EXAMPLE OF THIS WOULD BE: VIOLATIONS OF THIS WILL RESULT IN A FINE OF \$1000.00 FOR THE FIRST OFFENSE, \$1500.00 FOR THE SECOND, AND \$2000.00 FOR THE THIRD, ETC. IF PHYSICAL DAMAGE IS DONE TO THE TREE, AN APPRAISAL OF THE TREE AND TREES WILL BE DETERMINED. AN ARBORIST, AS REQUESTED BY THE CONSULTING ARBORIST, AND BE BASED ON ALL, OR PERCENTAGE OF THE ESTABLISHED VALUE ASSIGNED TO THE TREE.

ROOT BARRIER DETAIL

ROOTBALL LOCATIONS TO BE 6' AWAY FROM WATER/SEWER/UNDERGROUND UTILITY LINES AND HARDSCAPE WITH USE OF ROOT BARRIER, AND 10' AWAY WITHOUT ROOT BARRIER.

LANDSCAPE CALCULATIONS

ITEMS	REQUIREMENT	LENGTH (L.F.)	REQUIRED	PROPOSED
NORTH BUFFER	1 TREE/ 40 L.F.	150	4 TREES	4 TREES (4 PIGEON PLUMS)
EAST BUFFER	1 TREE/ 30 L.F.	120	4 TREES	4 TREES (4 GUMBO LIMBOS)
SOUTH BUFFER	1 TREE/ 40 L.F.	150	4 TREES	4 TREES (4 PIGEON PLUMS)
WEST BUFFER	1 TREE/ 30 L.F.	120	4 TREES	4 TREES (4 COCONUT PALMS)
STREET TREES	1 TREE/ 40 L.F.	120	3 TREES	3 TREES (3 GUMBO LIMBOS)
MIN. DEVELOPMENT SITE LANDSCAPE	1 TREE/ 3,000 S.F	(18,000 S.F.)	6 TREES	6 TREES (6 JAPANESE BLUEBERRIES)
	TOTAL TREES		25 TREES	25 TREES
PALM TREES	MIN. 20% OF TOTAL		4 PALMS MAX.	4 PALMS
NATIVE TREES	MIN. 50% OF TOTAL		13 TREES	13 TREES
SPECIES	MIN. 4 SPECIES		4 SPECIES	4 SPECIES
INTERIOR SHRUBS	5 SHRUBS/ 3,000 S.F.(18,000 S.F.)		30 SHRUBS	>30 SHRUBS